



Installing CrownWall® Around a Window Frame

Before installing the CrownWall® system around a window, there are a few important considerations to be made in order to achieve the best final result. This guide will help you understand those considerations.



WATCH OUR INSTALLATION VIDEOS: crownwall.com/install

Tools to Cut Panels



Oscillating Saw



Jig Saw

(If Required)



Miter Saw

Tools to Cut Trim



Scissors/Snips

Before Panel Installation

Before proceeding, the first consideration is the area around your window. When starting out, you will have a bare wall as seen below. It is important to understand the stud structure behind that wall.

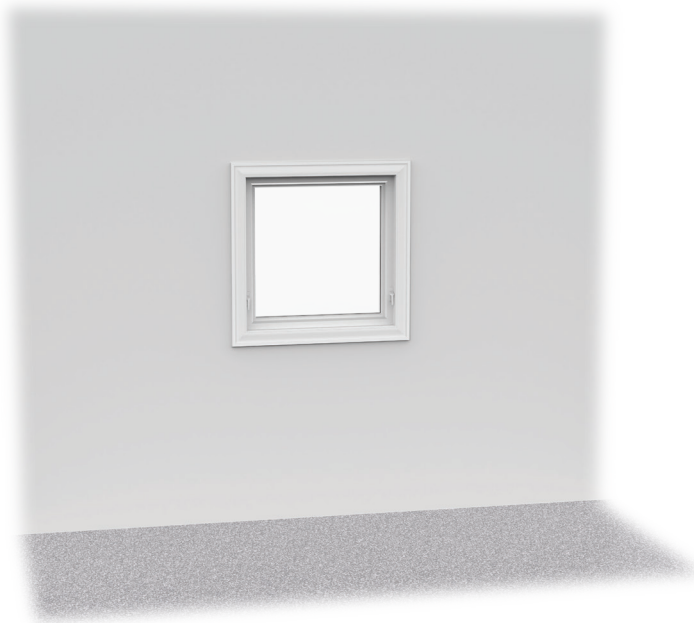

Bare wall surrounding window

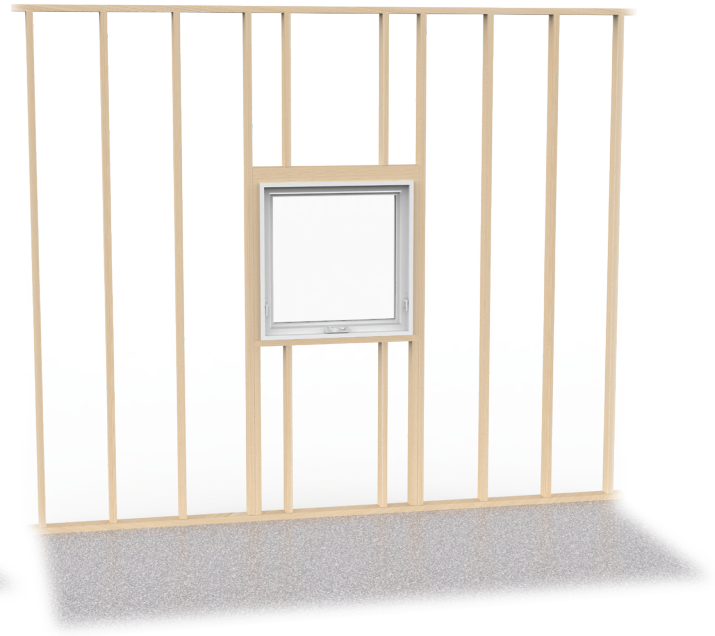

Stud structure found behind this section of wall

Stud Structure

The typical and most common stud structure found around a window is as seen below. However, there may be slight variations from structure to structure. Ensure to locate these studs before proceeding with any panel installation.

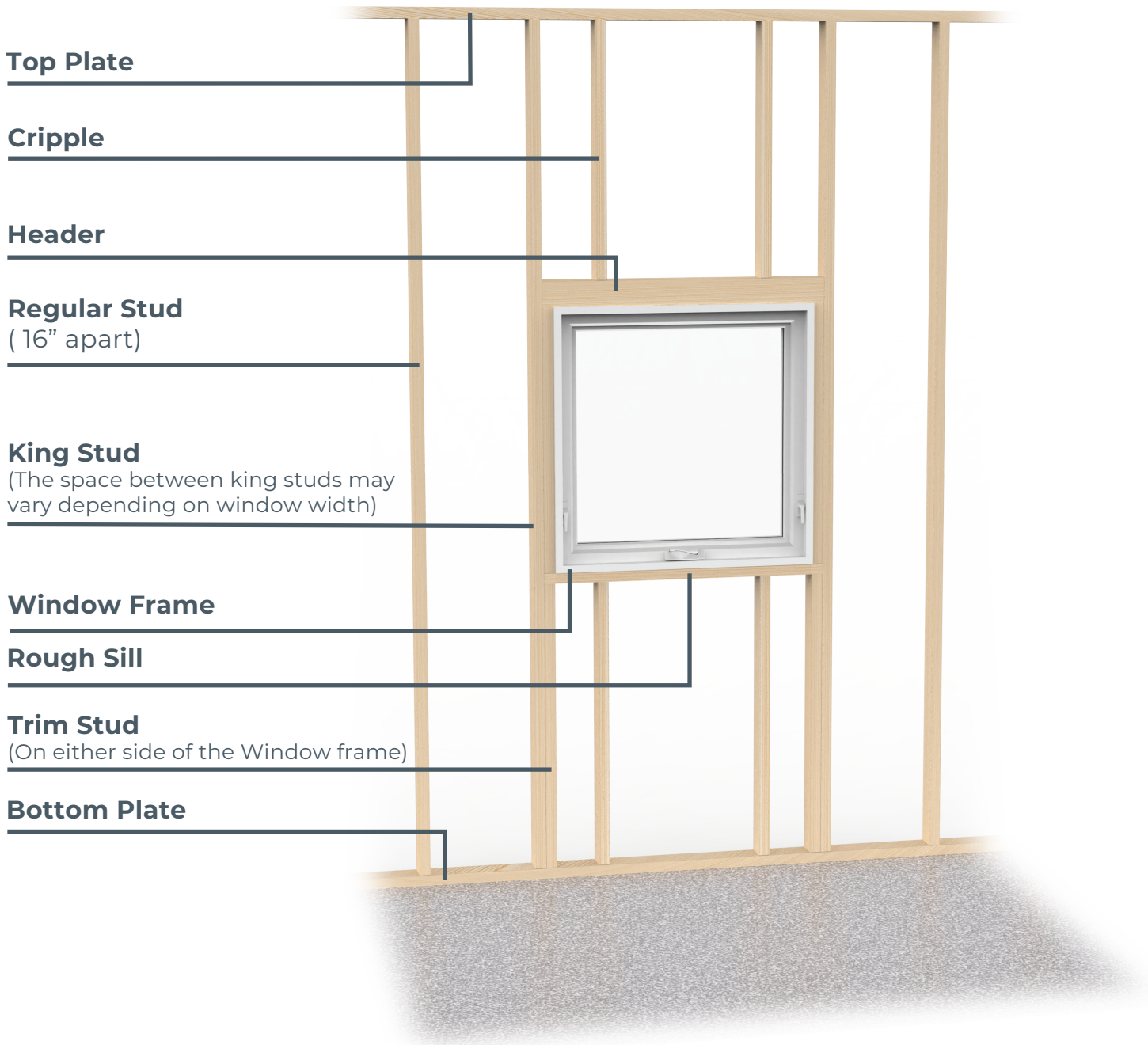

Installation Guide

To achieve the best results around your window, the panels should stop at either side of the vertical portions of the window frame. The panel segments are separated above and below the window frame by sections of H-Trim, as shown below, while the wall sections on either side of the window frame are capped with J-Trims. This will create four wall sections: one above, one below and one on either side of the window frame.

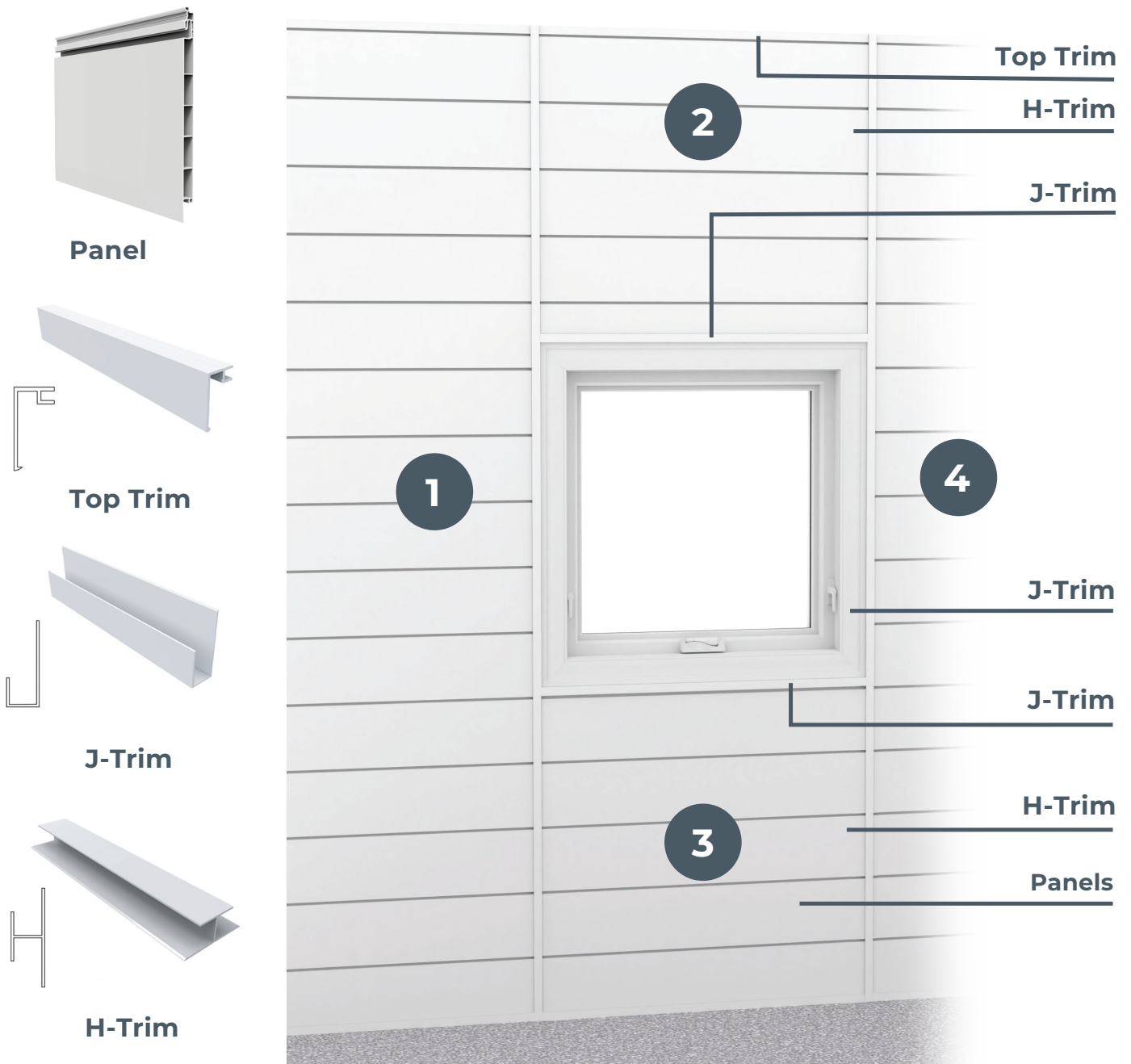

Step 1

J-Trim is first cut to the length of the wall section (as far as the window frame) then installed on the bottom of the slat wall sections, regardless of how far up the wall the panels begin.

The wall sections above and below the window frame are separated by H-trim sections that run from the bottom J-trim up until the J-trim around the window frame. Ensure that the H trim is installed with the larger portion of the “H” facing in and against the wall.

J-Trim
(Bottom)

H-Trim

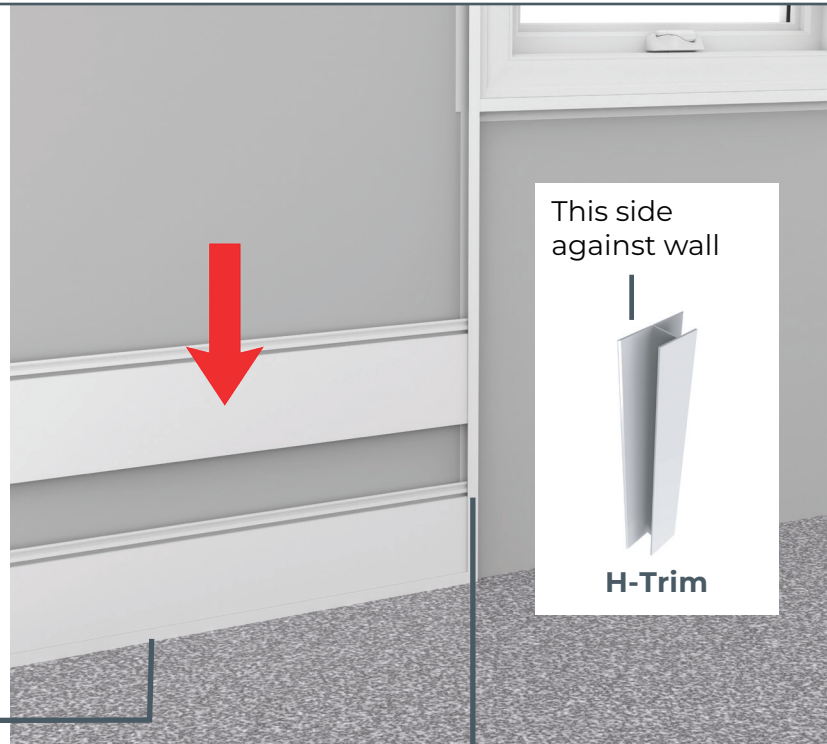

Continue installing the wall section, with the length going no further than the window frame. Ensure that the J-trim is oriented around the window frame as shown.

J-Trim
(Extending up to the top of the Window)

J-Trim

J-Trim

H-Trim



Step 2

Below the window frame, repeat step 1 panel installation by cutting the panels no longer than the width of the window frame. H-Trim sections are used to separate the wall sections.

H-Trim

H-Trim



Step 3

Repeat step 2 above the window, starting with a J-trim on the top of the window frame.

Note: There may be instances where you must cut along the length of the panels to ensure that all of the panels match in elevation. Seen to the right is an example of this where the starting panel is cut narrower to match the wall section next to it.

J-Trim



Step 4

With the panel sections above and below the window installed, the next section of panels can be installed on the opposite side of the window frame.

This will conclude the installation of panels around your window.

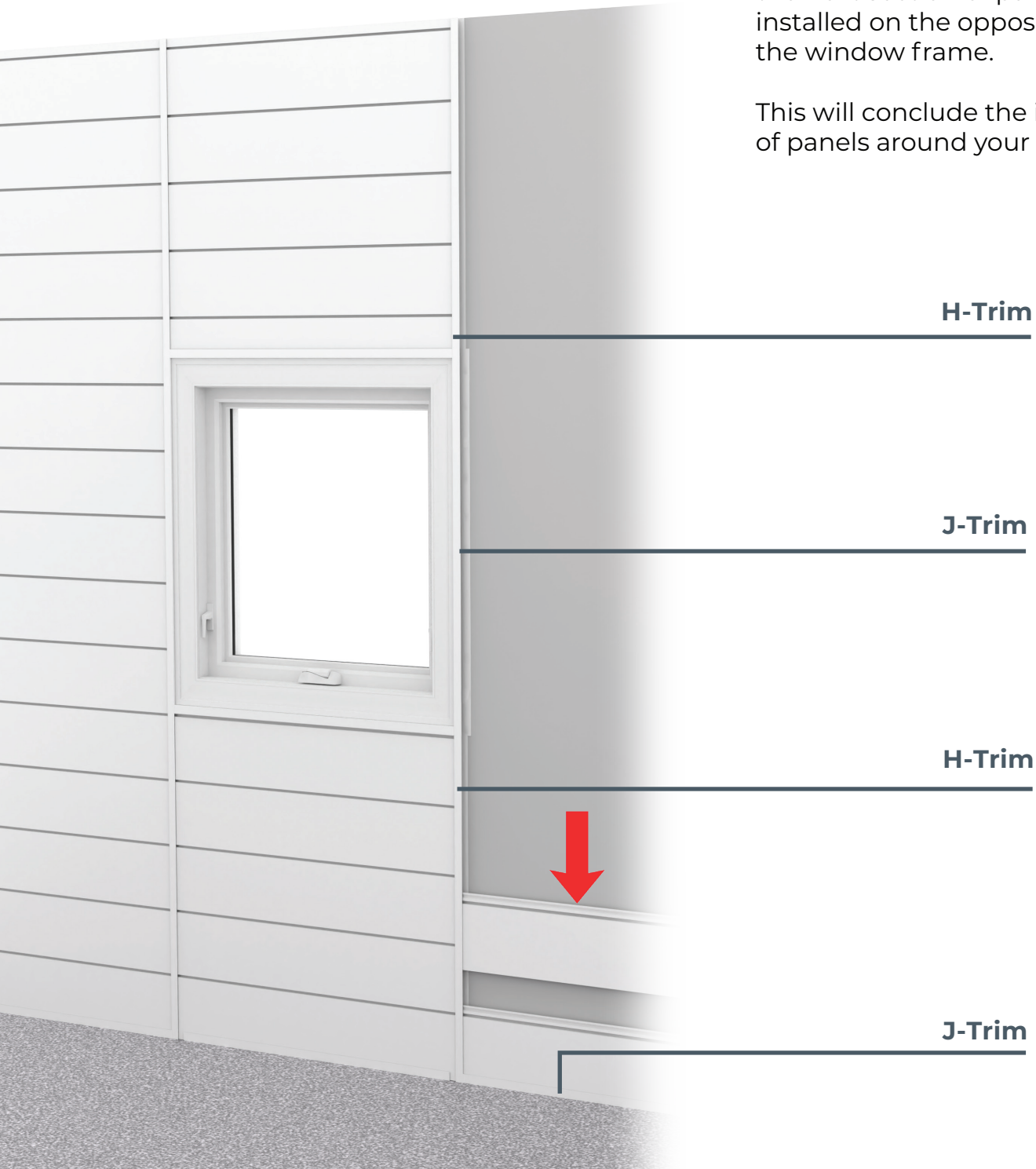

Final Result